

PE Series

Ideal for classrooms and corporate conference rooms



Bright, affordable and compact laser projector with broad zoom and lens shift

Powerful Performance

- After startup images appear immediately with breakthrough laser technology
- Brightness adjustment maximize laser life and allow for a consistent looking image over an extended period of time
- High performance video processing/scaling supports 4K/30 content
- Integrated software support for Crestron Roomview, AMX Beacon, PJ Link control systems

4K UHD
READY

More Flexible Installations

- Lens shift capabilities make alignment easy
- Tilt-free installation capabilities make these projectors ideal for almost any install environment, including portrait orientation



Advanced Installation Features

Lens Shift

Lens shift provides greater flexibility when determining install location

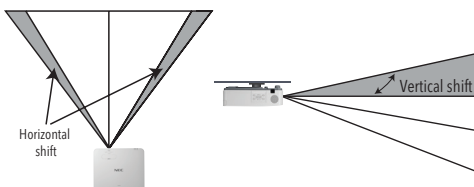

Tilt-free

The projector can be rotated freely (360°) to orient the image depending on the installation requirements

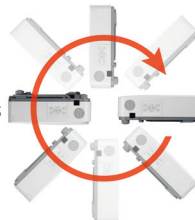

Portrait mode

Allows the projector to be rotated (and screen if necessary) to a vertical alignment so that portrait content can be viewed without black bars on the side when landscape mode is used.

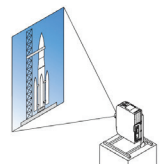

MultiPresenter

MultiPresenter is application software that lets you display your device's screen (PC, tablet, smart phone, etc.) on the receiver projectors via wired or wireless LAN. MultiPresenter is free and available on Windows, Mac, iOS, and Android. MultiPresenter can send images from your various devices, which enables you to display real-time images with the internal camera or web pages on the smart devices in combination with a file sharing application.

MultiPresenter™

NaViSet Administrator 2

This software is an all-in-one remote support solution that runs from a central location and provides monitoring, asset management and control functionality for a majority of NEC display devices and Windows computers. It is ideal for multi-device installations over larger infrastructures.



UNIQUE FEATURES

Advanced AccuBlend™ ensures detailed images when non-native resolution sources are connected to the projector

Remote diagnostics enable the user to monitor and make adjustments to the projector remotely

Built-in HTTP page for control and monitoring over a LAN network. Email notification of error messages or lamp end-of-life can be sent to remote locations.

WARRANTY

Registered owners receive a five (5) years parts and labor warranty.

SHIPS WITH

Remote control, batteries, power cord, user's manual on CD-ROM, quick start guide, product registration card.

ACCESSORIES

NP05LM1 Wireless LAN Module
 RMT-PJ39 Replacement remote control

ORDERING MODEL NUMBER

NP-PE506UL



NP-PE506UL



NP-PE506UL



NP-PE506UL



NP-PE506UL

		PE506ULG
Display Technology		0.64" LCD
Light Output (lumens)	Center	5,500
	ECO mode OFF	5,200
	ECO1 mode	Approximately 60%
	ECO2 mode	Approximately 50%
Resolution	Native	WUXGA 1920 x 1200
	Maximum	Up to 4K@30 (HDMI), WUXGA (1920x1200) Analog
Contrast Ratio (up to)		3,000,000:1
Laser Life (50%)	ECO mode OFF	20,000 hours
	ECO2 mode	30,000 hours
Screen Size (diagonal)		30 - 300 in. / 0.76 - 7.62m
Projection Distance		2.6 to 44.3 ft. / 0.8 to 13.5m
Projection Angle		0 - 10.8° tele / 0 - 17° wide (at 60°)
Lens	Zoom	Manual
	Zoom Ratio	1.6x
	Throw Ratio	1.22 - 1.98:1
	Focus	Manual
	F-number, focal length	F:1.5~2.08 / f=17.2~27.7mm
	Shift	Manual (H = +/- 29% / V = -0%~+60%)
Keystone Correction		+/- 30° horizontal (manual), +/- 30° vertical (manual + auto)
Synchronization Range	Horizontal	15-100kHz (RGB: 24kHz or over)
	Vertical	24-85Hz
SD/HD Video Signal Compatibility		480i, 480p, 576i, 576p, 720p, 1080i, 1080p, 4K UHD
PC Signal Compatibility		VGA, SVGA, XGA, SXGA, SXGA+, UXGA, WUXGA
Macintosh Compatibility		Yes
Input Terminals	RGB1 (analog)	VGA 15-pin D-sub
	RGB2 (digital)	HDMI w/ HDCP (v1.4b)
	RGB3 (digital)	HDMI w/ HDCP (v1.4b)
	Audio In	Stereo Mini Jack
Output Terminals	Monitor Out	VGA 15pin D-sub
	Audio Out	Stereo Mini Jack
Wired LAN port		RJ45 (100Base-TX/10Base-T)
USB	Type A	Wireless LAN (optional), Memory, (2.0A)
	Type B	Service
External Control		RS-232 (D-Sub 9pin), IR, LAN
Built-in Speaker		16W
Power Requirements		100-240V AC, 50/60 Hz
Input Current		4.5-1.6A
Power Consumption	ECO mode OFF	352W
	ECO1 mode	228W
	ECO2 mode	201W
	Standby (network)	2.0W or less
	Standby (normal)	0.5W or less
Installation Orientation		Floor/Front, Floor/Rear, Ceiling/Front, Ceiling/Rear
Product Dimensions (WxHxD)		15.9 x 5.4 x 14.7 in. (405 x 137 x 373 mm)
Net Weight		17.5 lbs. (7.95 kg)
Shipping Dimensions (WxHxD)		20.1 x 10.2 x 19.7 in. (510 x 260 x 500 mm)
Gross Weight		21.9 lbs. (9.95 kg)
Fan Noise		37dB (ECO mode Off), 27dB (ECO mode)
Regulations		USA: UL (UL60950-1/UL62368-1) FCC Part15 Class B, Canada: CAN/CSA (62368-1-14) ICES-003 Issue 7
Operating Temperature		32-104°F / 0-40°C
Storage		14-122°F / -10-50°C
Humidity		20 to 88% Humidity (Non-Condensing)



HDMI, the HDMI Logo and High-Definition Multimedia Interface are trademarks or registered trademarks of HDMI Licensing LLC. HDBaseT™ and the HDBaseT Alliance logo are trademarks of the HDBaseT Alliance. All other brand or product names are trademarks or registered trademarks of their respective holders. Product specifications subject to change.

NEC Australia Pty Ltd reserves the right to change product specifications, functions, or features, at any time, without notice. Please refer to your local NEC representatives for further details. Although all efforts have been made to ensure that the contents are correct, NEC shall not be liable for any direct, indirect, consequential or incidental damages resulting from the use of the equipment, manual or any related materials. The information contained herein is the property of NEC Australia Pty Ltd and shall not be reproduced without prior written approval from NEC Australia Pty Ltd.

For more information, visit nec.com.au, email contactus@nec.com.au or call 131 632

©2022 NEC Australia Pty Ltd. All rights reserved. NEC and NEC logo are trademarks or registered trademarks of NEC Corporation that may be registered in Japan and other jurisdictions. All other trademarks are the property of their respective owners. All rights reserved. Printed in Australia. Note: This disclaimer also applies to all related documents previously published.